

A 355L frost free single door refrigerator with a classic white finish, FlexSpace™ interiors & Spillsafe™ glass shelving. Can be paired with freezer model WFB2804WA to provide you with plenty of fresh food and freezer storage.

RRP NZ \$1,849.00



Product Details

FEATURES

Spillsafe™ glass shelves	Quick chill function	FlexStor™ door bin storage system	LED lighting
Pigeon pairing capability	Door alarm	Full-width crisper	Multi-flow air delivery system
Electronic temperature controls	R600a refrigerant better for the environment	Reversible door	

BENEFITS

FlexSpace™, it's size redefined
 With a busy lifestyle and a growing family, you can always do with more space in your fridge. That's why Westinghouse created FlexSpace™, which is designed to maximise storage, flexibility and access to meet your ever-changing needs. Big enough to handle even the biggest grocery shop, you'll be able to fit in all your food and drinks with ease.

Adjustable solutions with FlexStor™
 As your family changes and grows, so do the requirements of your fridge. With FlexStor™ you enjoy the convenience of being able to easily change the configuration, whatever your needs. Adjust the height and position of the door bins to fit in large and smaller items and arrange your fridge your way.

Pigeon Pair
 Westinghouse's vertical fridges and freezers can be combined in one space to give you a pigeon pair. This provides you with the maximum fresh food and freezer storage in one unit- truly the big fridge for the big family

Easy to clean with Spillsafe™ glass shelves
 Spillsafe glass shelves improve visibility and isolate leaks. Preventing up to 1 litre of spills from dripping onto shelves below

Specifications

PRODUCT PROFILE

Domestic warranty details (yrs)	2
Additional domestic warranty for the sealed refrigeration system only (yrs)	3
Refrigerator Type	vertical fridge
Exterior door finish	White
Handle design	bar handle
Fridge door opening	reversible
Cooling system	frost free
Refrigerant	R600a

ENERGY

Energy Star Rating AS/NZS 4474.2:2009	3.0
Energy consumption AS/NZS 4474.2:2009 (kWhr/yr)	237

DIMENSIONS

Total height (mm)	1746
Cabinet height (mm)	1746
Total width (mm)	595
Cabinet width (mm)	595
Total depth (mm)	700
Cabinet depth (mm)	560
Depth door open 90degree (mm)	1175
Total Gross Capacity (L)	355
Food compartment capacity (net in litres)	355

REFRIGERATOR SYSTEM

Controls	electronic (with display)
Controls location	external
Controls type	touch

FOOD COMPARTMENT

SHELVING

Shelf material	glass
Type of shelf	spill safe shelf

LIGHTING

Main light	LED
------------	-----

REFRIGERATOR SYSTEM

Control functions	holiday mode,quick chill
Door alarm	fridge

CRISPERS

Crisper lid/shelf	glass
Crispers Runner system	rollers
Full width crisper	2

FOOD COMPARTMENT DOOR

BINS

Deep bottle bin	2
-----------------	---

Dimensions

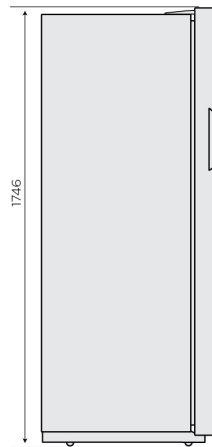
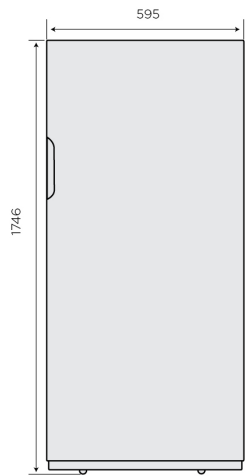

Recommended minimum clearances

Please note: Doors are designed to sit proud of cabinetry (not flush).

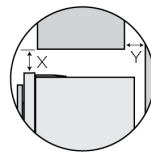

If you have a cupboard above the refrigerator with a rear gap of less than 100mm (Y), recommended minimum clearance at the top of the refrigerator increases from 30mm to 70mm (X).

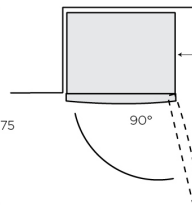
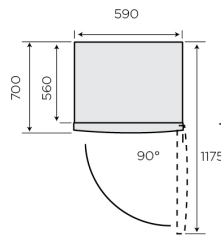
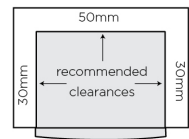

When positioned in a corner area, clearance of at least 350mm on the hinge side will allow the doors to open enough to enable the removal of the bins and shelves.

Terms and Conditions

IMPORTANT

This is a guide of product dimensions only. For complete installation instructions, refer to the manual provided with product.

PRODUCT INFORMATION

The descriptors and illustrations in this publication apply to the specific products and models described as at the date of issue. Under our policy of continuous product development, product specifications may change without notice. Prospective purchasers should therefore check with their retailer to ensure this publication correctly describes the products that are being offered for sale. All information supplied is to be used for general reference purposes only and is on the understanding that Electrolux Home Products Pty Ltd (Australia) and Electrolux (NZ) Ltd (New Zealand) will not be liable for any loss, liability or damage of whatever kind arising as a result of reliance on such information. Colours of products illustrated are as close as printing limitations allow. Electrolux will at all times comply with its obligations pursuant to law including Trade Practices (Australian Consumer Law) Act and Regulations.

WARRANTY

This warranty only applies to Appliances purchased and used in Australia or New Zealand and used in normal domestic applications and is in addition to (and does not exclude, restrict, or modify in any way) any non-excludable statutory warranties in Australia or New Zealand. All warranties are subject to the conditions set out in the warranty card accompanying the product when purchased.

ELECTROLUX HOME PRODUCTS AUSTRALIA

telephone: 1300 363 640

fax: 1800 350 067

email: customercare@electrolux.com.au

web: www.electrolux.com.au

ELECTROLUX HOME PRODUCTS NEW ZEALAND

telephone: 09 573 2230

fax: 09 573 2221

email: customercare@electrolux.co.nz

web: www.electrolux.co.nz