

**Serie | 4, integrated rangehood, 53 cm, Silver metallic
DHL555BAU**

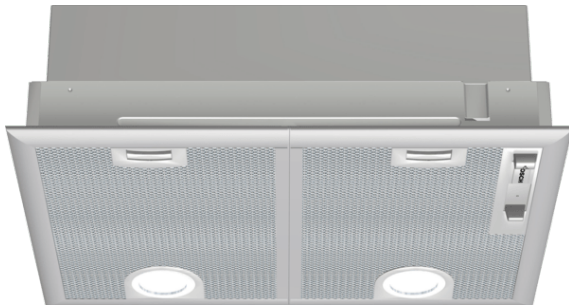

The canopy cooker hood: offers you flexibility in your kitchen planning - mount it either on the wall or above a kitchen island.

- **LED lighting:** for perfect, energy-efficient illumination of the cooktop.
- **Intensive speed setting with reset:** automatically resets the hood to normal speed setting after 6 min..
- **especially silent:** maximal extractor performance with minimal noise
- **Grease filtration level:** filters out over 85% of the grease from kitchen air
- **Intensive speed setting:** removes strong kitchen odours especially quickly and effectively.

Technical Data

Typology :	Traditional
Approval certificates :	Australia Standards, VDE
Length electrical supply cord (cm) :	130
Required niche size for installation (HxWxD) :	255mm x 500.0mm x 350mm
Minimum distance above an electric hob :	650
Minimum distance above a gas hob :	650
Net weight (kg) :	7.708
Type of control :	mechanical
Maximum output air extraction (m ³ /h) :	420
Boost position output recirculating (m ³ /h) :	430.0
Maximum output recirculating air (m ³ /h) :	320
Boost position air extraction (m ³ /h) :	650
Number of lights :	2
Noise level (dB) :	59
Diameter of air outlet (mm) :	120 / 150
Grease filter material :	Washable aluminium
EAN code :	4242002527093
Connection Rating (W) :	206
Voltage (V) :	220-240
Frequency (Hz) :	50
Plug type :	AU plug
Installation typology :	Built-in



4 242002 527093

**Serie | 4, integrated rangehood, 53 cm, Silver metallic
DHL555BAU**

The canopy cooker hood: offers you flexibility in your kitchen planning - mount it either on the wall or above a kitchen island.

Design

- 53 cm, Integrated Rangehood
- Appliance colour: Stainless steel
- Suitable for ducted or recirculating operation
- Powerful twin motor

Convenience

- 3 power settings plus intensive setting
- 2 x LED lighting
- Push Button controls for power and light
- 2 dishwasher-safe metal grease filters

Operating and power

- 120 or 150mm tube connected diameter
- Perforated stainless steel filter covers
- Extraction rate according to EN 61591:
 - Min: 210 m³/h
 - Intensive: 650 m³/h
- 206 W total connected load
- Noise level according to EN 60704-3 und EN 60704-2-13 exhaust air:
 - Max. normal use: 59 dB(A) re 1 pW sound pressure:45 dB(A)
 - Intensive: 69 dB(A) re 1 pW (55 dB(A) re 20 µPa sound pressure)

**Serie | 4, integrated rangehood, 53 cm, Silver metallic
DHL555BAU**

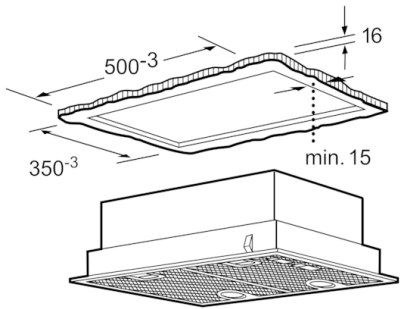

measurements in mm

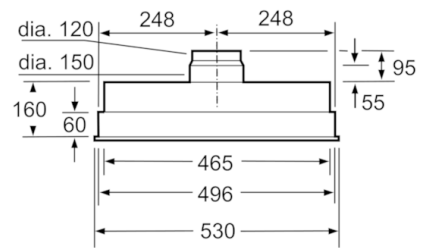

measurements in mm

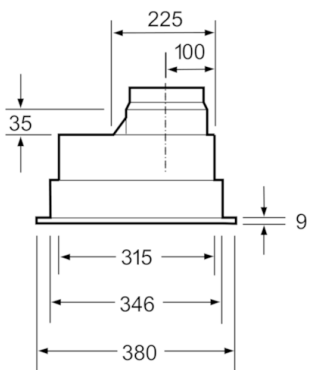

measurements in mm